

## DRYERBOX INSTALLATION

DRYER VENTING: MECHANICAL CONTRACTOR SHALL BE RESPONSIBLE FOR RUNNING ALL DUCTWORK FOR THE DRYER EXHAUST SYSTEM. ALL CONCEALED DRYER DUCTING MUST BE RIGID METAL (GALVANIZED OR ALUMINUM) MINIMUM OF 4" IN DIAMETER, SMOOTH 30 GA. CLEAN, UNOBSTRUCTED, FRICTIONLESS DUCTS (NO FLEXIBLE DUCT ALLOWED IN CONCEALED AREAS). SEAL ALL JOINTS WITH FOIL BACKED PRESSURE SENSITIVE DUCT TAPE MEETING THE REQUIREMENTS OF UL 181. DUCT JOINTS SHALL BE INSTALLED SO THAT THE MALE END OF THE DUCT POINTS IN THE DIRECTION OF THE AIRFLOW. DO NOT USE RIVETS OR SCREWS IN THE JOINTS OR ANYWHERE ELSE IN THE DUCT AS THESE WILL ENCOURAGE LINT COLLECTION.

DRYERBOX® RECEPTACLE (WWW.DRYERBOX.COM) SHALL BE METAL AND BE INSTALLED AS LOW AS POSSIBLE AS TO PERMIT THE PROPER AND SAFE COLLECTION OF THE DRYER TRANSITION HOSE. DRYERBOX SHOULD BE RESTING ON THE BOTTOM PLATE AND BE LOCATED AT OR NEAR THE CENTERLINE OF THE PROPOSED DRYER APPLIANCE (NOTE CENTERLINE MARK EMBOSSED IN WIDER MODELS (4D, 3D AND 480)). RIGID DUCT SHOULD PENETRATE DRYERBOX PORT 2 INCHES TO PROVIDE FOR FUTURE CONNECTION AND STORAGE OF TRANSITION HOSE. BASEBOARD SHALL BE "BUTTED" UP TO THE FIXED EXTENSION RIM AND SLIGHTLY BACK-CUT. DRYERBOX SHOULD BE CAULKED AND THEN PAINTED WITH THE TRIM PAINT.

LENGTH OF CONCEALED RIGID METAL DUCTING SHALL NOT EXCEED 35 FEET. DEDUCT 5 FEET FROM THE ALLOWABLE LENGTH FOR EVERY 3.5" RADIUS 90 DEGREE ELBOW AND TWO AND A HALF FEET FOR EVERY 45 DEGREE FITTING. DRYER VENTING SHALL BE INDEPENDENT OF ANY OTHER SYSTEMS (CHIMNEYS OR EXHAUST VENTS). TERMINATION OF DRYER VENTING MUST BE TO THE EXTERIOR WITH A PROPER HOOD OR ROOF JACK EQUIPPED WITH A BACK-DRAFT DAMPER. SMALL ORIFICE METAL SCREENING SHOULD NOT BE PART OF THE HOOD OR ROOF JACK AS THIS WILL ACCELERATE LINT ACCUMULATION AND BLOCKAGE. THE HOOD OPENING SHOULD POINT DOWN AND EXHIBIT 12 INCHES OF CLEARANCE BETWEEN THE BOTTOM OF THE HOOD AND THE GROUND OR OTHER OBSTRUCTION. VERIFY APPLIANCE MANUFACTURER'S RECOMMENDATIONS FOR ANY OTHER FACTORS.

**DIRECTIONS:**  
 PROVIDE BLOCK MASON A PREASSEMBLED DRYERBOX WITH A SHORT 6 INCH NIPPLE AND ELBOW COMING OUT OF THE TOP. INSTALLER SHOULD KNOCK OUT THE BLOCK AND WEBBING CREATING A RECESS OR "SOAP" IN THE BLOCKS BEHIND THE PROPOSED DRYER FOR DRYERBOX ASSEMBLY. INDICATE THE WALL IS SINGLE OR DOUBLE FIRRED SO INSTALLER ONLY REMOVES WHAT IS NEEDED. ONCE INSTALLER GETS THIS ASSEMBLY TO FIT, COAT ALL EXPOSED MATERIAL WITH A HEAVY TRUCK BED COATING SPRAY OR SIMILAR PRIOR TO POURING TIE-BEAM. USE SPRAY FOAM WHERE NECESSARY AND PREP FOR TIE-BEAM POUR LIKELY POURING WITH THE ASSEMBLY IN-PLACE.

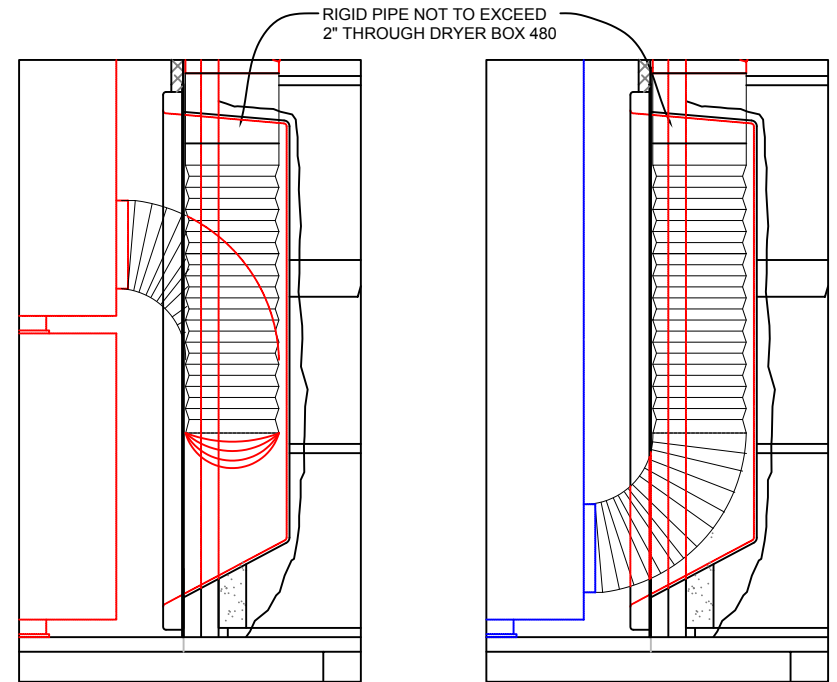
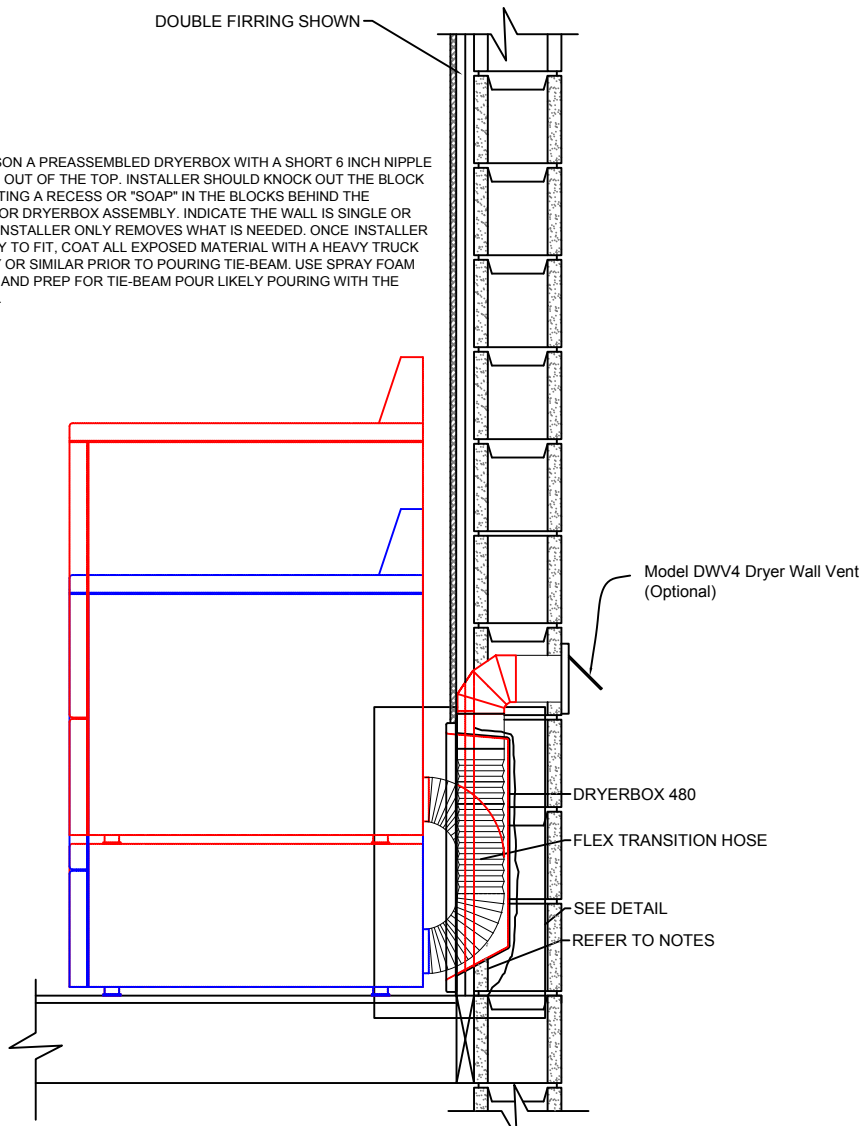

PEDESTAL MOUNT

STAND-ALONE

### DRYERBOX DETAIL

SCALE 1 1/2" = 1'-0"

Standard bottom plate installation accommodates stand-alone and pedestal mounted dryers for upward or downward venting.

Overall dimensions: 23 1/2" H x 17 3/8" W x 5 1/8" D  
 Inside dimensions: 20 1/2" H x 14" W x 4 1/4" D

MANUFACTURED BY:  
 In-O-Vate Technologies, Inc.  
 810 Saturn Street, Suite 21  
 Jupiter, FL 33477 USA  
 (888) 443.7937  
 www.dryerbox.com

US Patent No. :  
 5,476,183 and 6,419,102 and 7,7341,045

PRODUCT  
**DRYERBOX MODEL 480**

INSTALLATION  
**DETAILS FOR CONCRETE WALL, UP**

MATERIAL  
**22GA. ALUMINIZED STEEL 0.018**

SCALE  
**3/4" = 1'-0"**

DATE  
**11.13.2012**